

PPDI

Polypropylene Encapsulated Ductile Iron, ANSI Flanges/Backup Rings for use on HDPE and PP Piping Systems. Pressure Rated with Safety Factors

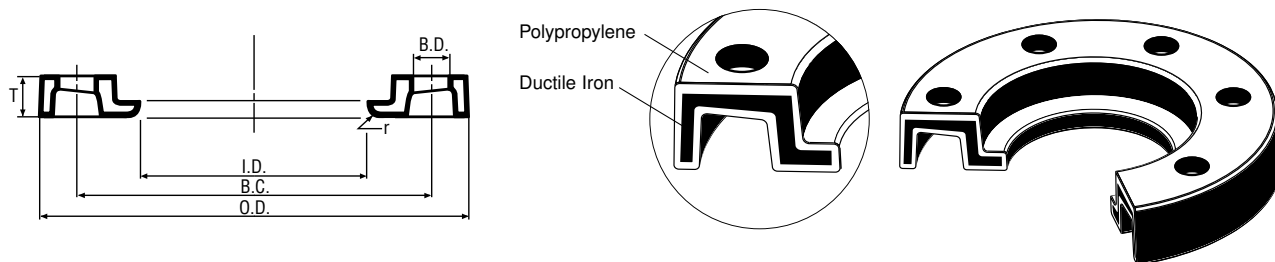

- **Description** A highly corrosion resistant flange for HDPE stub-ends. Full Polypropylene fiberglass reinforced injection molded Deltaflex convoluted flange.
- **Utilization** An economic alternative where corrosion resistance of flanges is advisable.
- **Dimensions** Bolt circles are ANSI B16.5, class 150. Mates with ANSI B16.5, B16.47, AWWA C207.
- **Material** Glass reinforced polypropylene with IPP Deltaflex ductile iron insert (ASTM A536).

Pipe Diameter	Product Code	Outside Dia. O.D.	Flange Thick. T	Inside Dia. I.D.	Bolt Count N	Bolt Hole B.D.	Bolt Circle B.C.	Radius r	Weight lbs/pc	HDPE ¹ Operating Pressure
2"	PPDI-SDR13.5-02	6.50	0.71	2.46	4	0.75	4.75	0.28	1.5	128
3"	PPDI-SDR13.5-03	7.80	0.71	3.60	4	0.75	6.00	0.35	2.0	128
4"	PPDI-SDR13.5-04	9.21	0.71	4.60	8	0.75	7.50	0.35	2.5	128
6"	PPDI-SDR13.5-06	11.57	0.79	6.75	8	0.87	9.50	0.35	4.0	128
8"	PPDI-SDR13.5-08	13.86	1.10	8.75	8	0.87	11.75	0.35	7.5	128
10"	PPDI-SDR13.5-10	16.61	1.22	10.92	12	1.02	14.25	0.35	10.5	128
12"	PPDI-SDR13.5-12	19.37	1.61	12.92	12	1.02	17.00	0.35	17.5	128
14"	PPDI-SDR13.5-14	21.26	1.61	14.38	12	1.14	18.75	0.35	23.0	128
16"	PPDI-SDR13.5-16	23.82	1.75	16.19	12	1.14	21.25	0.35	30.0	128
18"	PPDI-SDR13.5-18	25.51	1.91	18.38	16	1.26	22.75	0.35	34.0	128
20"	PPDI-SDR13.5-20	27.87	2.13	20.38	20	1.26	25.00	0.35	42.0	128
24"	PPDI-SDR13.5-24	32.52	2.24	24.38	20	1.38	29.50	0.35	58.5	128
28"	PPDI-SDR13.5-28	36.95	2.99	28.39	28	1.38	34.00	0.35	105.0	128
30"	PPDI-SDR13.5-30	39.45	3.13	30.38	28	1.38	36.00	0.35	119.0	128
36"	PPDI-SDR13.5-36	46.65	3.86	36.38	32	1.61	42.75	0.35	197.0	128

1. Operating pressure on an HDPE stub-end with a safety factor of two.

Polypropylene Encapsulated Ductile Iron, ANSI Flanges/Backup Rings for use on HDPE and PP Piping Systems. Pressure Rated with Safety Factors

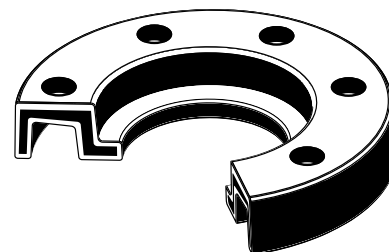
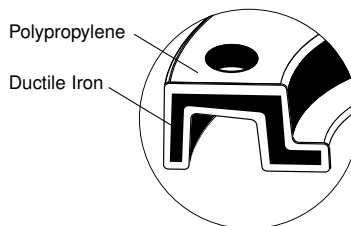
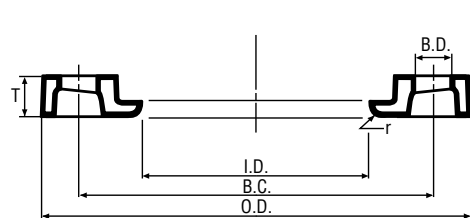

- **Description** A highly corrosion resistant flange for HDPE flange adapters. Full Polypropylene fiberglass reinforced injection molded Deltaflex convoluted flange.
- **Utilization** An economic alternative where corrosion resistance of flanges is advisable.
- **Dimensions** Bolt circles are ANSI B16.5, class 150. Mates with ANSI B16.5, B16.47, AWWA C207.
- **Material** Glass reinforced polypropylene with IPP Deltaflex ductile iron insert (ASTM A536).

Pipe Diameter	Product Code	Outside Dia. O.D.	Flange Thick. T	Inside Dia. I.D.	Bolt Count N	Bolt Hole B.D.	Bolt Circle B.C.	Radius r	Weight lbs/pc	HDPE ¹ Operating Pressure
2"	PPDI-SDR7-02	6.46	0.71	2.63	4	0.75	4.75	0.28	1.8	275
3"	PPDI-SDR7-03	7.72	0.73	3.75	4	0.75	6.00	0.28	2.4	275
4"	PPDI-SDR7-04	9.33	0.98	4.75	8	0.75	7.50	0.35	4.2	275
6"	PPDI-SDR7-06	11.69	1.18	7.09	8	0.88	9.50	0.35	7.1	275
8"	PPDI-SDR7-08	13.94	1.34	8.88	8	0.88	11.75	0.35	11.6	275
10"	PPDI-SDR7-10	16.73	1.52	11.00	12	1.00	14.25	0.35	16.0	275
12"	PPDI-SDR7-12	19.57	2.01	13.19	12	1.00	17.00	0.35	28.2	275
14"	PPDI-SDR7-14	21.34	2.05	14.38	12	1.13	18.75	0.35	35.7	275
16"	PPDI-SDR7-16	23.90	2.44	16.38	16	1.13	21.25	0.35	66.4	275
18"	PPDI-SDR7-18	25.51	2.44	18.38	16	1.25	22.75	0.35	60.6	275
20"	PPDI-SDR7-20	27.99	2.68	20.38	20	1.25	25.00	0.35	93.5	275
22"	PPDI-SDR7-22	30.31	3.19	22.38	20	1.38	27.25	0.35	104.9	275
24"	PPDI-SDR7-24	32.52	3.19	24.38	20	1.38	29.50	0.35	142.2	275
28"	PPDI-SDR7-28	37.20	3.90	28.38	28	1.38	34.00	0.35	224.4	275
30"	PPDI-SDR7-30	39.21	3.90	30.38	28	1.38	36.00	0.35	247.1	275

1. Operating pressure on an HDPE flange adapters with a safety factor of two.