



- Parts Description
- New Products
- Fusion Tapping Saddle
- Threaded Transitions
- Grooved Transitions
- Weld-On Transitions
- Pulling Heads
- MJ Adapter
- Copper/HDPE Adapters
- PVC/HDPE Adapters
- Gas Transitions
- Quick Disconnects
- ID Controlled Weld-Ons
- Additional Transitions
- Polypress Installation Tools
- Poly Fittings
- Poly Fittings with Transition
- Custom Fittings

[Product Specs](#) | [Submittal Page](#) | [Print](#)

**Series 710
Transition with
Male NPT**



POLY-CAM Male Threaded Transition Adaptors (710 Series) is a multi-level mechanical transition fitting, patent number 5,211,429. The POLY-CAM Threaded Transition is manufactured to the following;

- Carbon Steel Epoxy Coated, 304 and 316 Stainless Steel
- Other steel materials can be made depending on availability.
- Sizes range from .5 to 12" NPT
- Meets ANSI/ASME B1.20-1983 R 1992
- All materials comply with AWWA and NSF 61 Meets ASTM 2513 Category 3. Upon request Poly-cam can install a stainless steel insert to meet ASTM 2513 Category 1

SDR 7		SDR 9		SDR 11		SDR 17		
NOMINAL SIZE INCHES	COUPLING O.D. "A"	PRESSED SDR11 PE PIPE I.D. "B"	EXPOSED SDR11 PE PIPE I.D. "C"	EXPOSED PE PIPE O.D. "D"	COUPLING LENGTH "E"	EXPOSED PE PIPE LENGTH "F"	OVERALL LENGTH "G"	THREAD LENGTH "H"
0.5	1	~0.625	0.67	0.84	1.6	6.4	8	0.64
0.75	1.25	~0.79	0.84	1.05	1.8	6.2	8	0.7
1	1.32	~0.84	1.05	1.32	2	6	8	0.99
1.25	1.66	~1.06	1.34	1.66	2.6	5.4	8	1.01
1.5	1.9	~1.28	1.53	1.9	2.6	5.4	8	1.03
2	2.38	~1.64	1.92	2.38	3	5	8	1.06
2.5	2.88	~1.99	2.31	2.88	3.5	4.5	8	1.25
3	3.5	~2.42	2.83	3.5	4	4	8	1.26
4	4.5	~3.23	3.63	4.5	4	8	12	1.48
5	5.53	~4.0	4.49	5.56	5	7	12	1.5
6	6.63	~4.8	5.35	6.63	5	8	13	1.56
8	8.63	~6.3	6.96	8.63	7	8	15	1.75
10	10.75	~7.9	8.68	10.75	8	8	16	1.85
12	12.75	~9.5	10.29	12.75	9	9	18	2.27

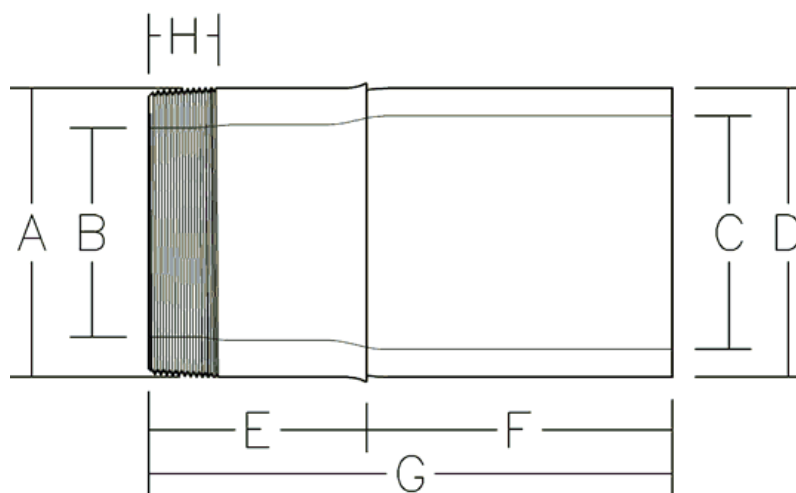

11/00 © Registered Trademark Poly-Cam, Inc. - US Patent # 5,211,429

copyright 2009 Poly-Cam